

## Toilet Alarm Kit

### Features

- ▶ Only 3 points to install on a standard system, and can be simply linked or expanded to other systems
- ▶ Sounder within the reset unit to give audible reassurance help is on the way
- ▶ Kits supplied with twin pull cord rings
- ▶ Braille text on the reset unit as well as disabled persons sticker
- ▶ Multi-way remote indicator units available
- ▶ Assist in compliance with the Equality Act 2010 & other care standards
- ▶ Suitable for commercial and public buildings



### Description

The Safe-Point Toilet Alarm Kit is simple to install and provides peace of mind wherever an indication of 'assistance required' is called for. Meeting the required standards for all disabled toilets fitted with emergency toilet alarm.

Upon raising an alarm, the reset unit responds with a reassuring audible sound which confirms assistance is on the way. In addition the unit has Braille text.

The units are supplied in white PVC enclosures to fit discreetly into any decor or environment.

### Toilet Alarm Kit

Product Code	Enclosure Type	Enclosure Material/finish
K41700SWP	Surface	PVC/white

### Specifications

Dimensions (mm)	Enclosure: 87 (W) x 87 (H) x 38 (D)
Weight	1Kg

### Typical Installation Scenario

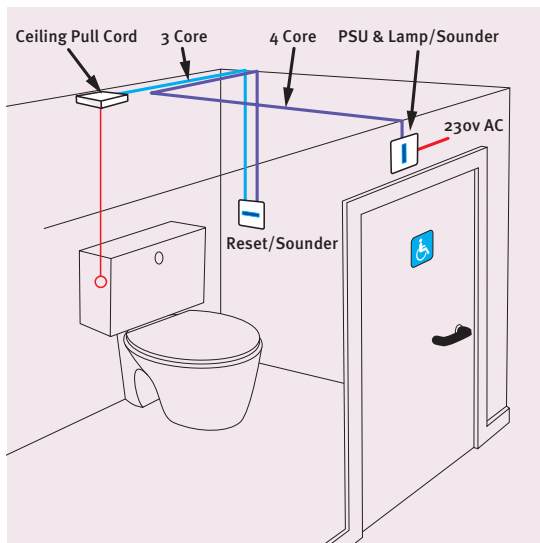

### Typical System

