

16-Way Disabled Refuge Control Panel

Features

- ▶ Disabled Refuge Control Panel
- ▶ 16x Call/answer outstation inputs
- ▶ Simple, handset operation
- ▶ Alarm indicators and internal buzzer
- ▶ Power on and system fault indicators
- ▶ Lamp test and silence buzzer push button
- ▶ Loop wired outstations
- ▶ Enable 'In Fire' input to prevent non-essential calls
- ▶ Integrated display to show custom alarm information
- ▶ Tamper resistant vision window cover



K41216FST

Description

The master panel can answer or call out to each, multiple or all of the Safe-Point disabled refuge outstations by activating the corresponding fascia push-buttons. Once connected full duplex conversations can take place and calls are ended by simply replacing the integrated handset.

Accompanying LED indicators and an internal buzzer notify of any disabled refuge alarms raised. A fascia located momentary push-button provides lamp-test and buzzer silence functionality. Added LED's provide power health and system fault indications.

Outstations are wired to the refuge master panel in a loop configuration reducing installation time and costs. Any toilet alarm kit can be wired in-line with an accompanying disabled refuge call/answer point.

Space for 7Ah batteries is provided within the cabinet, these will provide 24 + 3 hours standby as specified by BS5839 Part 9. The unit is available in surface or flush mount enclosure options, comprising a mild steel back box with stainless steel fascia plate, including a tamper resistant vision window cover.

Typical Installation Scenario (Loop connectivity)

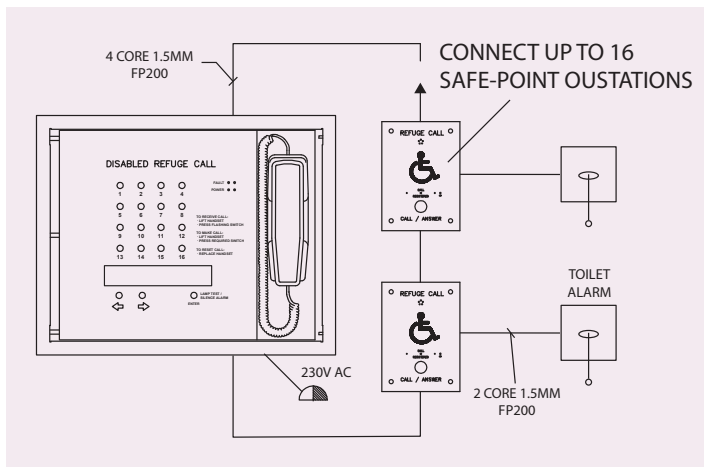

16-Way Disabled Refuge Master Panel

Product Code	Enclosure Type	Enclosure Material / finish	Connectivity
K41216FST	Flush	Stainless steel fascia, mild steel back box	Loop
K41216SST	Surface	As above	Loop

Specifications

Dimensions (mm)	Surface back box: 500 (W) x 400 (H) x 100 (D)
Weight	5Kg

Datasheet DS113 03/19 Rev.01

For further information visit www.kentec.co.uk

Kentec Electronics Ltd. reserve the right to alter the specification of its products from time to time without notice. Although every effort has been made to ensure the accuracy of the information contained in this document it is not warranted or represented by Kentec Electronics Ltd. to be a complete and up-to-date description.