

Disabled Refuge Outstations

Features

- ▶ Disabled Refuge outstations 'Type B'
- ▶ Single button 'hands-free' user operation
- ▶ Call registered and power on status indicators
- ▶ Straightforward 2 wire installation
- ▶ Toilet alarm input connections
- ▶ Induction loop included
- ▶ Output to mute local sounders/speakers
- ▶ Stainless steel or photo luminescent green fascias
- ▶ Etched text front stainless steel panel fascia
- ▶ Braille idents with photo luminescent green fascia
- ▶ 'Flush' or 'surface' mount enclosure options



Description

A convenient 'Type B' call/answer point, fully compatible with Kentec's Safe-Point range of products.

Fitted at Disable Refuge locations, at the touch of a button, the unit provides the means to effectively hold duplex voice conversations with building control operatives.

LED status indicators provide a visual sign that a call is registered and that power to the unit is healthy. An integrated induction loop provides assistance to hearing aid users.

Typical Installation Scenario

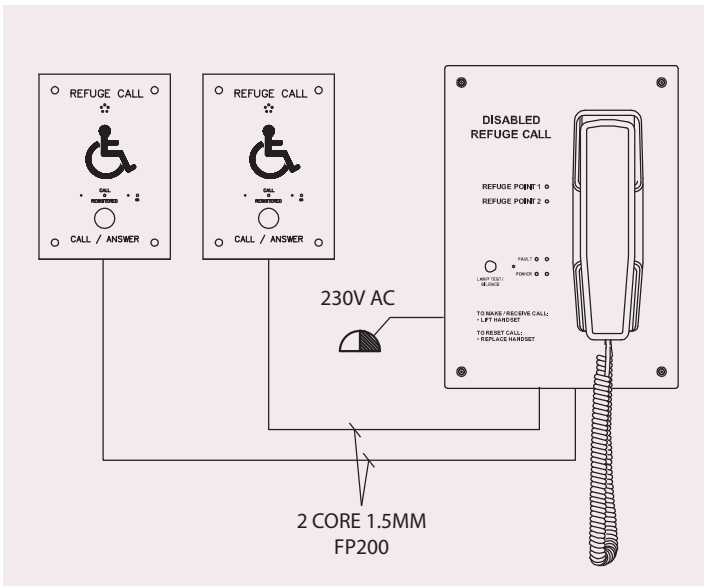

Front panel

Product Code	Panel Material/Finish
K41300NST	Stainless steel/Brushed
K41300NGR	Steel/Photo luminescent, green

Enclosure

Product Code	Enclosure Type	Enclosure Material /finish	Connectivity
K41600FGA	Flush	Stainless steel fascia, mild steel back box/ brushed, EPC black	Loop
K41600SGA	Surface	As above	Loop
K41500FGA	Flush	As above	Radial
K41500SGA	Surface	As above	Radial

Specifications

Dimensions (mm)	Front fascia: 224 (W) x 307 (H) x 1.5 (D) Flush back box: 204 (W) x 287 (H) x 83 (D)
Weight	1Kg